

Type voeding

|   |   |   |
|---|---|---|
| <p>6700041<br/>INPUT 230V~ 50-60 Hz<br/>OUTPUT 12V 0.8A</p> | <p>6700042<br/>INPUT 230V~ 50-60 Hz<br/>OUTPUT 12V 1A</p> | <p>6700043<br/>INPUT 230V~ 50-60 Hz<br/>OUTPUT 13.8V 5A</p> |
| <p>DIN</p>  | <p>DIN</p>  | <p>DIN</p>  |

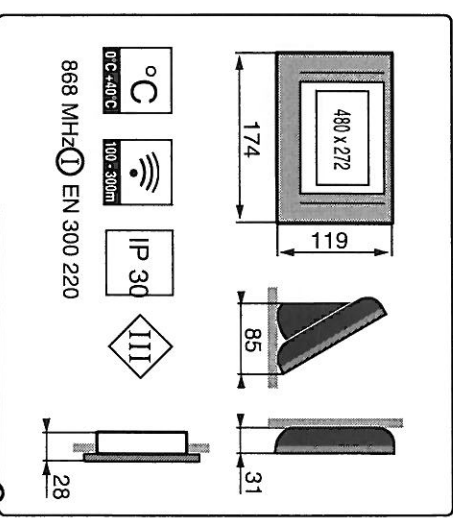

## 6. Configuratie

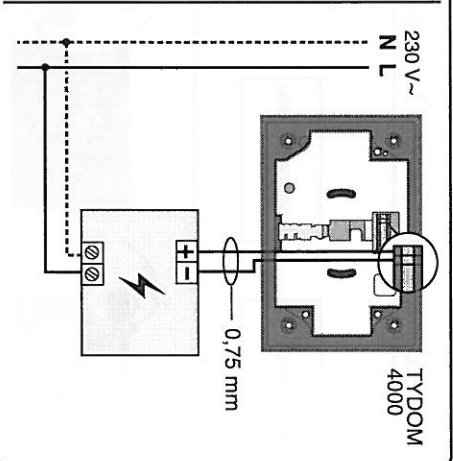
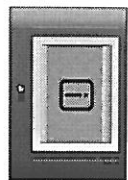

Taalkeuze

Datum instellen

Tijd instellen

2

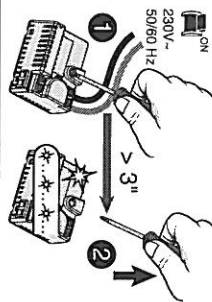
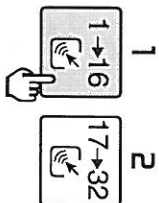
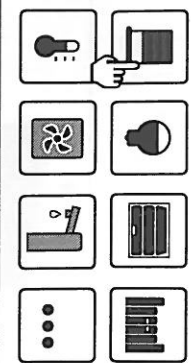

Start

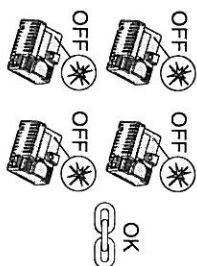
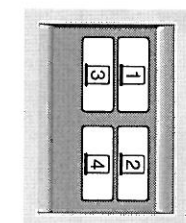
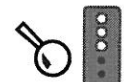

1 Zoeken



Naam geven

Een symbool kiezen



2 3 4 ...

3

Toegangscade installateur

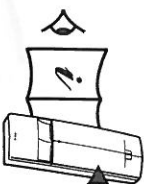
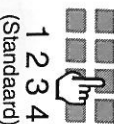

Menu "Product toevoegen"

Doorgaan

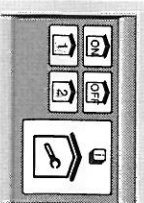
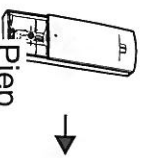

Alarm

4

Na het instellen, vergeet niet om uw toegangscode te wijzigen.

Geevanceerde instellingen

Vergrendeling

Toegangscade installateur

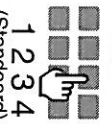

NEW \* \* \* \*

NEW X2 \* \* \* \*

5

Beveilig uw configuratie door een toegangsniveau in te stellen (niveau 1 of niveau 2 wordt aanbevolen)

Geevanceerde instellingen

Vergrendeling

Toegangsniveau

- 1 Geen aanpassing mogelijk met behulp van
- 2 Aanpassing van toetsen, scenario's en kamers
- 3 Toevoegen en verwijderen van producten die op afstand kunnen worden bediend

1 → RESET ?

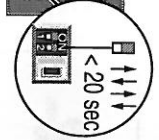
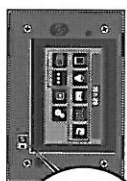
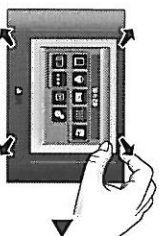

RESET NEE JA



1 2 3 4 (Standaard)

